

TIMBERWOLF



RELAX IN THE PACK.

DESTINATION TRAILERS

39HBA



39NA



39SR

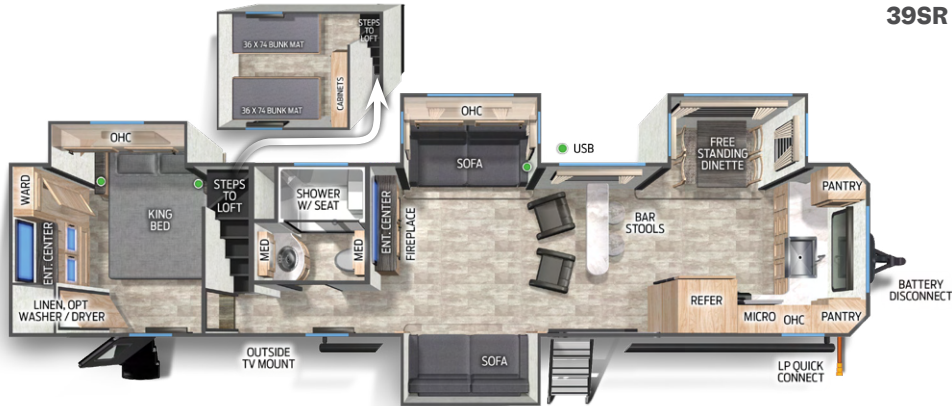

39TN

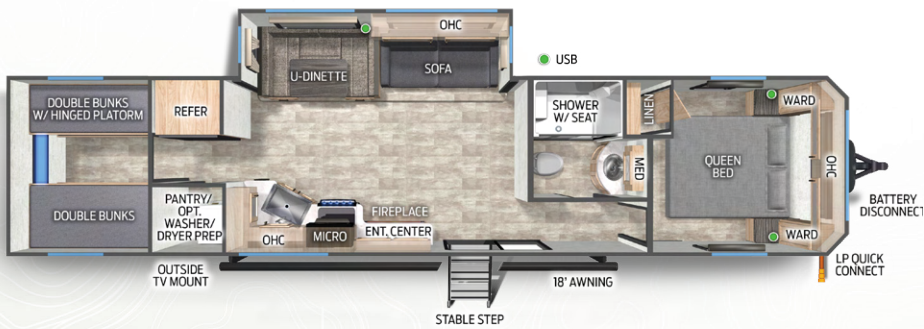

TIMBERWOLF

Limited Package

- Upgraded Kitchen Appliance Package
- Extra Large Shower with Full Surround
- Fireplace
- Detachable Power Cord
- LED Strip Lighting
- Light Filtering Sheer Shading Premium Zebra Blinds
- External LED Strip Lighting
- Premium Bedding Ensemble & Comforter
- LED Interior Lights
- Tire Pressure Monitors
- Power Gear Frame Technology
- Power Awning
- Cherokee Exclusive Stable Step with Oversized landing

- Supersized, Central Air Conditioning Unit with Quick Cool Air Dump Feature
- Residential Undermount Kitchen Sink
- Seamless Roofing Membrane with Heat reflectivity
- USB Charging Stations
- Exclusive Solar Thermo Controlled Reflective Tinted Safety Glass Windows
- Large Exterior Folding Assist Grab Handle
- On Demand Tankless Water Heater
- High Output Attic Fan in Bathroom
- Night Shades
- Outside Shower with Hot and Cold Water
- RV Grill Quick Connect
- Sky Light Over Tub

Standard Features

- Bluetooth Radio
- Real Blackout Glass, Safety Slam Friction Hinge Entry Door with Window & Shade Prep
- Interior & Exterior Ghost Lights
- External Porch Scare Light
- Cherokee Backup Camera System
- Ladder Prep
- Outside TV Bracket & Hookups
- 2nd Air Conditioning Unit



PRE-DELIVERY INSPECTION FACILITY

20,000 square feet of quality assurance. The bare essentials for a premium product. This state-of-the-art facility gives immediate daily feedback to production for quality assurance in every unit built.



24/7 EMERGENCY ROADSIDE ASSISTANCE WITH VEHICLE PURCHASE*

TOWING
JUMP-STARTS
TIRE CHANGES
FLUID DELIVERY
LOCKOUT
SERVICE

WINCH-OUT
MOBILE MECHANIC
TECHNICAL
SUPPORT
DEALER LOCATOR
SERVICES



*VALID FOR 1 YEAR FROM DATE OF PURCHASE



Learn More

Scan this barcode using a QR Reader on your smart phone to learn more about Forest River.



A Berkshire Hathaway company.



FREE MEMBERSHIP
to Forest River Owners' Group

www.forestriverfrog.com



CUSTOMER SATISFACTION



www.ForestRiverBuyLocal.com

Specification Definitions

UVW (Unloaded Vehicle Weight)* - is the typical weight of the unit as manufactured at the factory. It includes all weight at the unit's axle(s) and tongue or pin and LP Gas. The UVW does not include cargo, fresh potable water, additional optional equipment or dealer installed accessories.

*Estimated average based on standard build optional equipment.

CCC (Cargo Carrying Capacity)** - is the amount of weight available for fresh potable water, cargo, additional optional equipment and accessories. CCC is equal to GVWR minus UVW. Available CCC should accommodate fresh potable water (8.3 lbs per gallon). Before filling the fresh water tank, empty the black and gray tanks to provide for more cargo capacity.

** Estimated average based on standard build optional equipment

All information contained in this brochure is believed to be accurate at the time of publication. However, during the model year, it may be necessary to make revisions and Forest River, Inc., reserves the right to make all such changes without notice, including prices, colors, materials, equipment and specifications as well as the addition of new models and the discontinuance of models shown in this brochure. Therefore, please consult with your Forest River, Inc., dealer and confirm the existence of any materials, design or specifications that are material to your purchase decision. Litho. U.S.A. FOR 2388 P/W: 2023.12.01

YOUR **TIMBERWOLF** DEALER

